

## PNP General Purpose Transistor

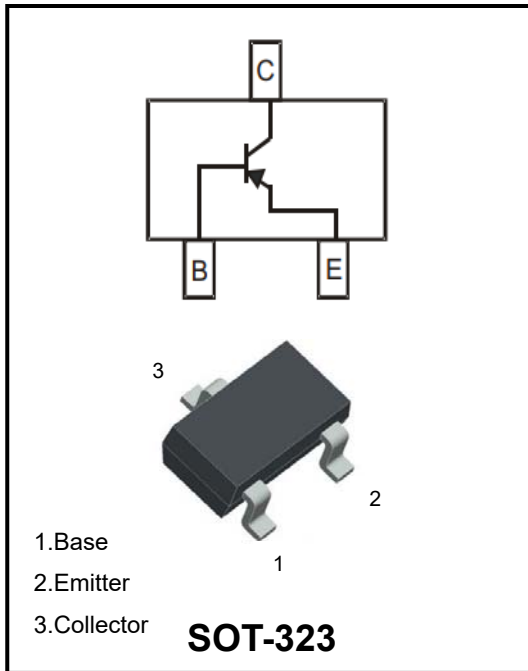

### Features

- Epoxy meets UL-94 V-0 flammability rating and halogen free
- Moisture Sensitivity Level 1
- Part no. with suffix "Q" means AEC-Q101 qualified

### Applications

- General purpose switching and amplification

### Mechanical Data

- Package: SOT-323
- Terminals: Tin plated leads, solderable per J-STD-002 and JESD22-B102
- Marking: FR.

### ■Maximum Ratings (Ta=25°C unless otherwise noted)

Item	Symbol	Unit	Rating
Collector-Base Voltage	$V_{CBO}$	V	-60
Collector-Emitter Voltage	$V_{CEO}$	V	-50
Emitter-Base Voltage	$V_{EBO}$	V	-6
Collector Current	$I_C$	mA	-150
Collector Power Dissipation	$P_C$	mW	200
Thermal Resistance From Junction to Ambient (*)	$R_{\theta JA}$	°C/W	625
Junction Temperature	$T_j$	°C	150
Storage Temperature	$T_{stg}$	°C	-55 to +150

### ■Ordering Information (Example)

PREFERRED P/N	PACKING CODE	UNIT WEIGHT(g)	MINIMUM PACKAGE(pcs)	INNER BOX QUANTITY(pcs)	OUTER CARTON QUANTITY(pcs)	DELIVERY MODE
2SA1576A-RQ	F2	Approximate 0.005	3000	30000	120000	7" reel



■ Electrical Characteristics (T<sub>a</sub>=25°C Unless otherwise specified)

Item	Symbol	Unit	Conditions	Min	TYP	Max
Collector-base breakdown voltage	V <sub>CBO</sub>	V	I <sub>C</sub> = -50μA, I <sub>E</sub> =0	-60		
Collector-emitter breakdown voltage	V <sub>CEO</sub>	V	I <sub>C</sub> = -1mA, I <sub>B</sub> =0	-50		
Emitter-base breakdown voltage	V <sub>EBO</sub>	V	I <sub>E</sub> = -50μA, I <sub>C</sub> =0	-6		
Collector-base cut-off current	I <sub>CBO</sub>	nA	V <sub>CB</sub> = -60V, I <sub>E</sub> =0			-100
Emitter-base cut-off current	I <sub>EBO</sub>	nA	V <sub>EB</sub> = -6V, I <sub>C</sub> =0			-100
DC current gain	h <sub>FE</sub>		V <sub>CE</sub> = -6V, I <sub>C</sub> = -1mA	180		390
Collector-emitter saturation voltage	V <sub>CE(sat)</sub>	V	I <sub>C</sub> = -50mA, I <sub>B</sub> = -5mA			-0.5
Output Capacitance	Cob	V	V <sub>CB</sub> = -12V, I <sub>E</sub> =0, f=1MHz		4	
Transition frequency	f <sub>T</sub>	MHz	V <sub>CE</sub> = -12V, I <sub>C</sub> = -2mA, f=100MHz		100	

■ Characteristics (Typical)

Fig.1 - Static characteristic

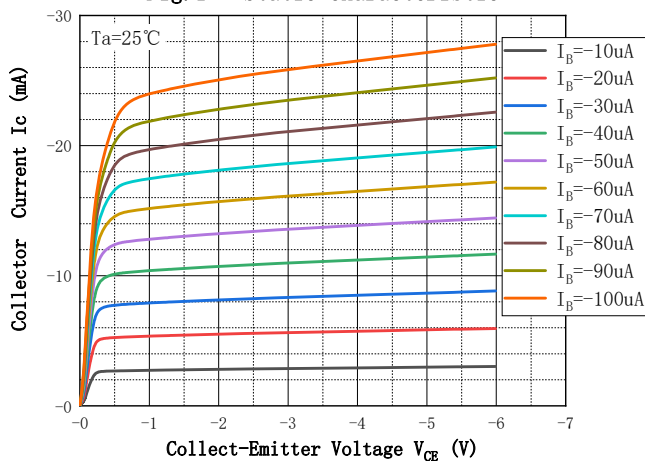

Fig.2 - DC Current Gain

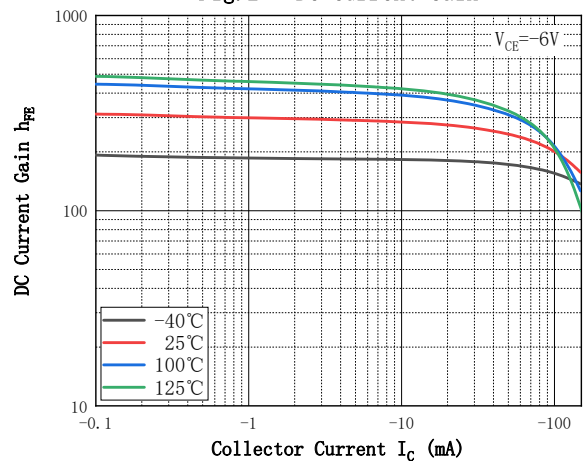

Fig.3 - Collect-Emitter Saturation Voltage

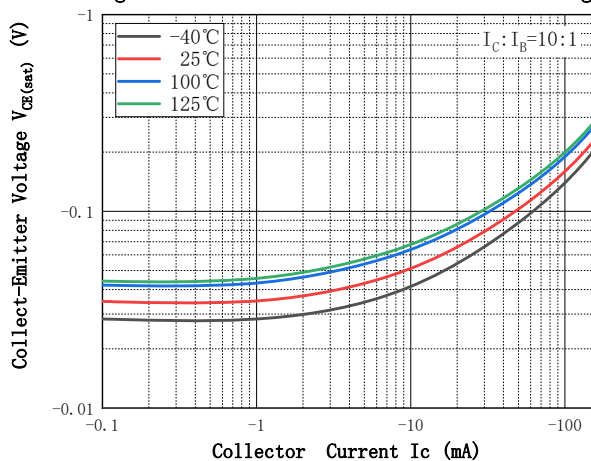

Fig.4 - Base-Emitter Voltage

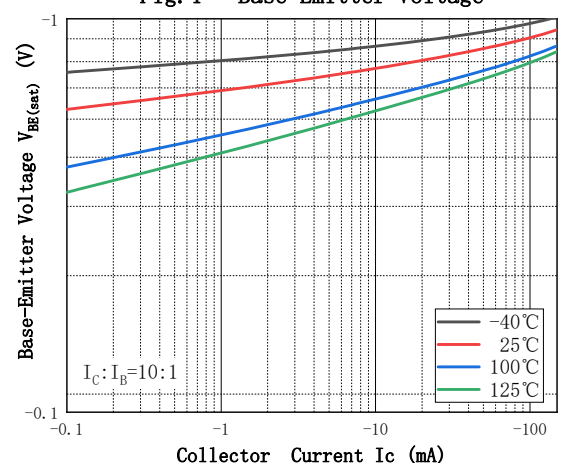

Fig. 5 - Base-Emitter On Voltage

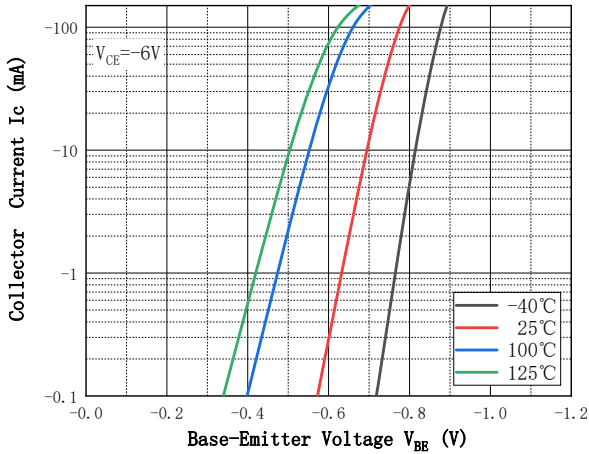
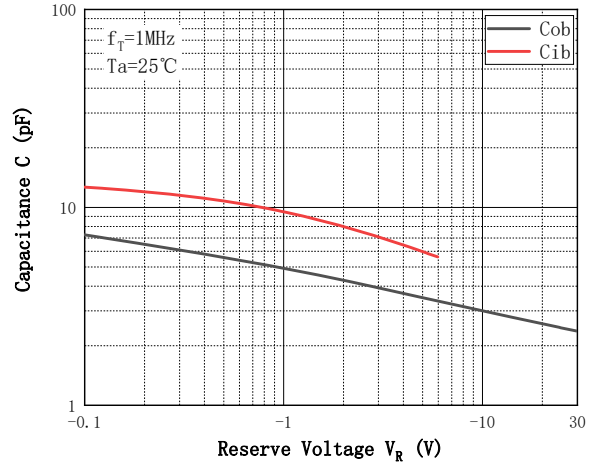
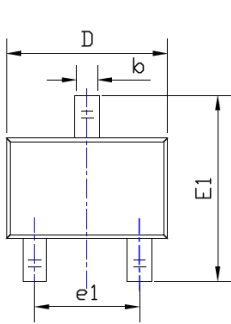

Fig. 6 - Cob/Cib—VCB/VEB



## ■ SOT-323 Package Outline Dimensions & Suggested Pad Layout



TOP VIEW

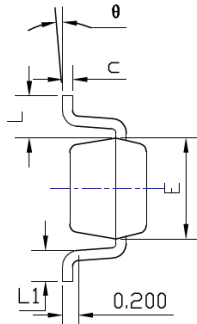

SIDE VIEW

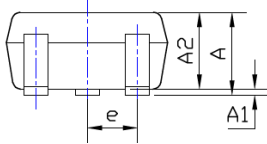

SIDE VIEW

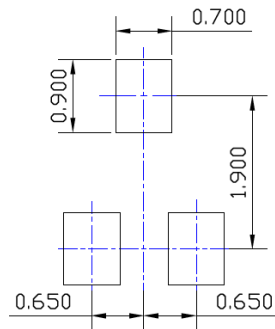

UNIT: mm

SUGGESTED SOLDER PAD LAYOUT

SYMBOL	DIMENSIONS			
	INCHES		Millimeter	
	MIN.	MAX.	MIN.	MAX.
A	0.035	0.043	0.900	1.100
A1	0.000	0.004	0.000	0.100
A2	0.035	0.039	0.900	1.000
b	0.006	0.016	0.150	0.400
c	0.004	0.010	0.100	0.250
D	0.071	0.087	1.800	2.200
E	0.045	0.053	1.150	1.350
E1	0.085	0.096	2.150	2.450
e	0.026TYP		0.650TYP	
e1	0.047	0.055	1.200	1.400
L	0.021REF		0.525REF	
L1	0.010	0.018	0.260	0.460
theta	0°	8°	0°	8°

**NOTE:**

- 1.PACKAGE BODY SIZES EXCLUDE MOLD FLASH AND GATE BURRS.
- 2.TOLERANCE 0.1mm UNLESS OTHERWISE SPECIFIED.
- 3.THE PAD LAYOUT IS FOR REFERENCE PURPOSES ONLY.



## Disclaimer

The information presented in this document is for reference only. Yangzhou Yangjie Electronic Technology Co., Ltd. reserves the right to make changes without notice for the specification of the products displayed herein to improve reliability, function or design or otherwise.

The product listed herein is designed to be used with automotive electronics, are not designed for use in medical, life-saving, lifesustaining, or military, Yangjie or anyone on its behalf, assumes no responsibility or liability for any damages resulting from such improper use of sale.

This publication supersedes & replaces all information previously supplied. For additional information, please visit our website [http:// www.21yangjie.com](http://www.21yangjie.com) , or consult your nearest Yangjie's sales office for further assistance.